

4,000 - 8,000 m ³ LNG carrier (propeller)	
Length	107.78 m
Breadth	28.00 m
Depth	4.50 m
Design draft	2.00 m
LNG cargo tank capacity	4,000 - 8,000 m ³ at 95%

4,000 - 8,000 m ³ LNG carrier (thruster IMO DPS 2)	
Length	102.90 m
Breadth	24.60 m
Depth	6.00 m
Design draft	2.00 m
Air draft	21.13 m
LNG cargo tank capacity	4,000 - 8,000 m ³ at 95%



Ultra-shallow draft LNG carrier

Features:

Designed with the forward and aft lines configured into a V-form to reduce the waterline entrance angle and consequently the vessel resistance in waves

Can be ballasted in open water to improve both stability and speed

Ultimate deck stiffness and strengthening will be determined to suit final operational envelope and desired class notation

Yards:

Batangas Heavy Fabrication Yard
San Roque, Bauan,
Batangas 4201

AG&P's full Azimuth Electric Drive IMO DP2 vessel is a workhorse designed specifically to meet the LNG delivery challenges presented by shallow rivers and restricted harbors. With a two-meter draft, the workhorse vessel is designed for both seagoing and riverine environments and is able to transfer LNG cargos near shore and offshore. Flexible and economical, the vessel has a speed of eight knots and does not need handling tugs. Its full Dynamic Positioning DP2 designation means versatile operation in any harbor.

Vessel propulsion and controls:

- Vessel propulsion is provided by 2 x DF 9L20DF engines rated 1665 kW
- Standby generator set of 1 x DF 6L20EF 1065 kW
- Moored vessel can provide 3500 kW shore power through shore interface
- Retractable azimuth thrusters

Cargo containment system:

- Cargo containment system is GTT MKIII membrane
- BOG 0.45 V% / d: 347 kg/hr
- Single tank with chamfered corners can withstand sloshing loads up to Beaufort Sea State 4/5 without reinforced foam
- Can discharge LNG into Type C tanks
- Capable of partial loading

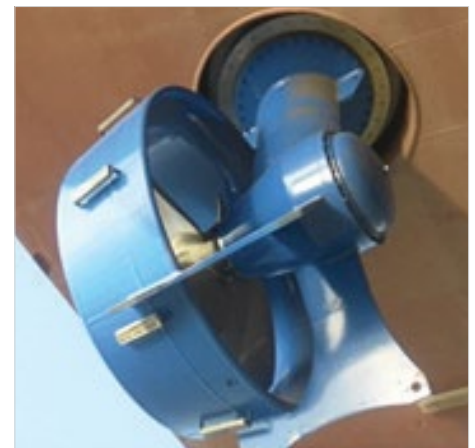

Retractable bow thruster

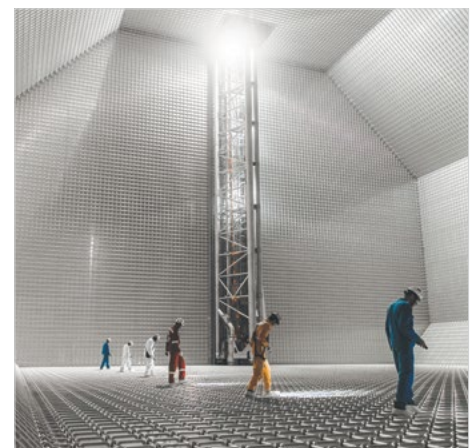

GTT's unique MKIII membrane

Cargo handling system:

- BOG handling has an optimized configuration
- Two liquid lines and single vapor return
- LNG cargo pumps rated at 600 m/hr
- CCS cooled down using spray pump
- CAM system fitted

Ordering and delivery:

- The ultra-shallow draft LNGC has a delivery time of approximately 14-16 months from order placement based on existing design specifications
- The standardized design features save money in engineering, procurement and build
- Capex is significantly optimized
- To discuss your specific requirements, please contact bd@agp.ph

**About AG&P**

Based in the Philippines, Atlantic Gulf & Pacific Company of Manila (AG&P) is at the forefront of the LNG infrastructure revolution providing gas or LNG to customers via integrated LNG receiving terminals and their supply chains. AG&P designs, manufactures, finances, leases, operates and maintains storage and regasification terminals, LNG-related assets, terminals and vessels. From sourcing gas to last-mile delivery, AG&P is the unique integrator that brings all parties together to deliver projects for lower, pragmatic capital cost.

For more than 118 years, AG&P has been a global leader in infrastructure solutions, delivering cutting-edge modularized products and support services to the energy, resources and industrial sectors. AG&P modularizes infrastructure for refineries, LNG export and import facilities, power, petrochemical and mining plants, building up to 125,000 tons of dense and complex modules each year.

For more information, visit www.agp.ph
